



2800 Campus Walk Avenue, Durham, North Carolina 27705 USA  
T +1 919.383.8575 F +1 919.383.6035 E [durham.us@millenniumhotels.com](mailto:durham.us@millenniumhotels.com) W [www.millenniumhotels.com](http://www.millenniumhotels.com)  
GDS Chain Code: MU Amadeus: RDUUNI Galileo: 76031 Sabre: 41127 Worldspan: RRDUU

### MEETINGS AND EVENTS

- Dedicated catering and convention service team
- 16,000 square feet of flexible meeting and function space
- Greenbriar and Brightleaf Ballrooms offer capacities of up to 300 banquet style
- Executive Boardroom for high-level meetings
- 19 meeting rooms
- 4,000 square feet of pre-function space
- Exhibit space
- In-house audiovisual and production support
- Customized food and beverage offerings

### AMENITIES AND SERVICES

- 316 guest rooms including seven suites and nine accessible rooms
- Award-winning Ask Alfred children's program
- Wired or Wi-Fi Internet
- Laundry and dry cleaning
- Meetings and events facilities
- Two self-service business centers
- Fitness center, heated indoor pool and whirlpool, sundeck
- Sundry/Gift shop
- Safe deposit box
- Hotel shuttle
- Complimentary on-site parking



Brightleaf Ballroom



Ballroom Theater

ROOM	FLOOR	AREA (SQ. FT.)	HEIGHT (FT)	LENGTH x WIDTH (FT)	THEATER	U-SHAPE	CLASSROOM	RECEPTION	CONFERENCE	ROUNDS
EXECUTIVE BOARDROOM	4	960	8	42 x 26	—	—	—	—	24	—
BRIGHTLEAF BALLROOM	3	3,864	10	92 x 42	400	100	200	500	—	300
BRIGHTLEAF E	3	966	10	42 x 23	90	25	50	80	30	70
BRIGHTLEAF F	3	920	10	40 x 23	90	25	50	80	30	70
BRIGHTLEAF G	3	920	10	40 x 23	90	25	50	80	30	70
BRIGHTLEAF H	3	966	10	42 x 23	90	25	50	80	30	70
BRIGHTLEAF PRE-FUNCTION	3	2,120	15	—	—	—	—	240	—	—
GREENBRIAR BALLROOM	2	3,864	10	92 X 42	400	100	200	500	—	300
GREENBRIAR A	2	966	10	42 x 23	90	25	50	80	30	70
GREENBRIAR B	2	920	10	40 x 23	90	25	50	80	30	70
GREENBRIAR C	2	920	10	40 x 23	90	25	50	80	30	70
GREENBRIAR D	2	966	10	42 x 23	90	25	50	80	30	70
GREENBRIAR PRE-FUNCTION	2	2,120	15	—	—	—	—	240	—	—
CONFERENCE SUITE 602, 603, 604	2	754	8	29 x 26	50	20	24	30	22	30
CONFERENCE SUITE 605 (BRIDAL SUITE)	2	754	8	29 x 26	—	—	—	25	—	—
CONFERENCE SUITE 502, 504, 505	1	754	8	29 x 26	50	20	24	50	22	30
CONFERENCE SUITE 503	1	754	8	29 x 26	—	—	—	—	12	—
ALUMNI ROOM	1	925	8	27 x 25	70	25	45	50	28	60
FACULTY ROOM	1	384	8	32 X 12	—	—	—	—	14	—
MILLENNIUM POOL DECK	1	2,500	15	—	—	—	—	150	—	100
POOL SUNDECK	1	1,800	—	—	—	—	—	100	—	80
BEL GUSTO COURTYARD	1	900	—	—	—	—	—	60	—	40
GRAND COURTYARD	1	11,570	—	85 X 136	—	—	—	1,650	—	1,100

**BRIGHTLEAF BALLROOM**

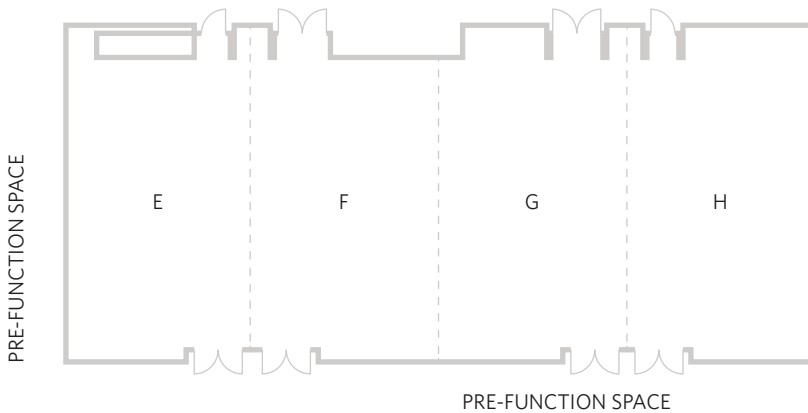

**GREENBRIAR BALLROOM**

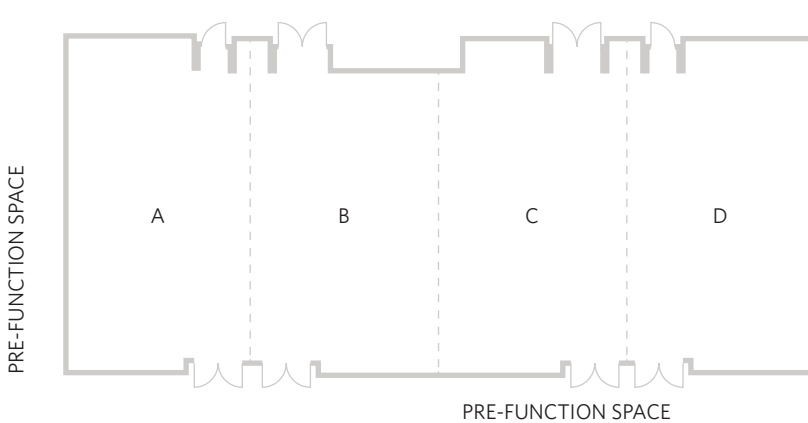

**EXECUTIVE BOARDROOM**

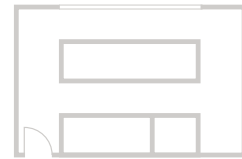

**ALUMNI ROOM**

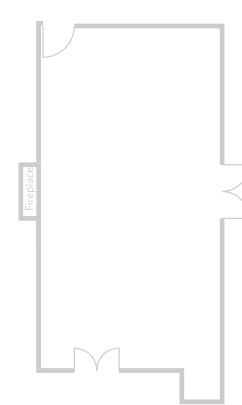

**FACULTY ROOM**



**CONFERENCE SUITES**

