

# Copthorne

WELLINGTON • ORIENTAL BAY



Let's Meet *Together*  
2024 Conference Pack



# Welcome to Wellington

Nestled between rolling green hills and the sparkling blue sea is New Zealand's 'Capital of Cool' Wellington, big enough to be exciting yet small enough to explore on foot. The country's financial and political centre, Wellington is home to Parliament, a thriving film industry and an array of exciting attractions. If you are into culture, then this is the city to come to with the interactive national museum, Te Papa, the New Zealand Symphony Orchestra, the Royal New Zealand Ballet, the Museum of Wellington City and Sea and the biennial New Zealand International Arts Festival. This vibrant, cross-cultural city is easily accessible to both international and domestic meetings and events.

## Location

The superb waterfront location makes the Copthorne Hotel Wellington, Oriental Bay the ultimate place to be with the city's sights and delights just footsteps away. A leisurely 15 minute walk brings you to city shopping, the commercial centre, theatres, Te Papa Museum and Courtney Place, home to great restaurants and bars. The hotel's strategic location positions it as a suitable accommodation choice for attendees of events at the nearby Takina, Wellington Convention and Exhibition Centre. An ideal choice for those seeking both comfort and accessibility in the dynamic city of Wellington.





# The Hotel

Located on Wellington's premier street, Oriental Parade, Copthorne Hotel Wellington Oriental Bay overlooks the harbour offering a visually stunning accommodation experience in Wellington. The well-appointed rooms are inspired by the surrounding natural environment and feature all the modern comforts you would expect from a contemporary city hotel.

Copthorne Hotel Wellington Oriental Bay is endorsed with a Qualmark 4 Plus star and an Enviro Silver rating. This establishes the hotel's position as a premier environmentally aware accommodation provider.

## **Guest Services**

- One80° Restaurant
- One80° Cocktail Lounge
- Complimentary wireless internet access in the hotel
- Access to full gym facilities
- Same day guest laundry and dry-cleaning services (Monday to Friday)
- Secretarial services



## Function Rooms

Copthorne Hotel Wellington Oriental Bay hosts three of the most premier conference rooms in the Wellington area. Specialising in meetings and conferences for up to 110 delegates theatre style, all three conference rooms are located on level 7 of the hotel. Easy access, natural light throughout and two stunning balconies provide the ultimate entertaining area with views second to none.

### Nicholson Room

The largest conference room at 124sqm, the Nicholson Room features natural light, individually controlled air-conditioning and comprehensive lighting with an extensive selection of audiovisual equipment. Situated beside the One80° Restaurant, this room has direct access externally for easy pack in and pack out.

### Jerningham Room







With floor to ceiling windows the Jerningham Room boasts natural light and dazzling harbour views. Incorporating natural tones with modern comforts, the room has both fluorescent and controlled down lighting, individually controlled air-conditioning and balcony access. This room is ideal for day meetings, intimate cocktail receptions and private dining.

### Pencarrow Boardroom

This purpose built boardroom features a fixed wooden table and executive style chairs seating up to 12 delegates. The Pencarrow Boardroom offers natural light, individually controlled air-conditioning and has a sliding door which opens out onto a large balcony with views over Wellington Harbour.

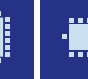

# Capacities

Conference Room	Area Sqm	Ceiling Height							
Nicholson Room	124	2.50m	110	70	90	120	33	39	64
Jerningham Room	86	2.50m	70	40	50	90	24	30	35
Pencarrow Boardroom	33	2.50m	-	-	-	-	10	12	-

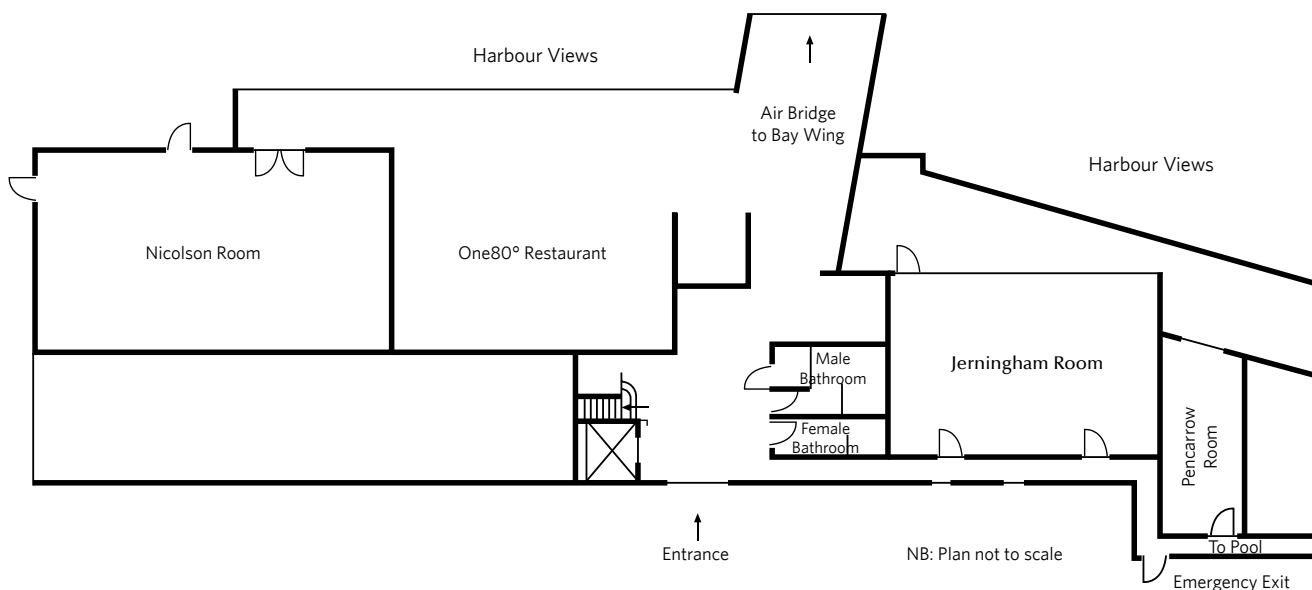



# Event Essentials

## Day Delegate Packages

**Full Day Delegate Package**  
 NZ \$74.00 per person per day includes:

Plenary venue hire

Morning tea

Buffet or working lunch

Afternoon tea

Projection screen

Whiteboard with markets

Flipchart with markers

Notepads, pens, iced water and mints

**Half Day Delegate Package**  
 NZ \$68.00 per person per day includes:

Plenary venue hire

Morning or afternoon tea

Buffet or working lunch

Projection screen

Whiteboard with markets

Flipchart with markers

Notepads, pens, iced water and mints

Delegate packages are available for bookings of 25 delegates or more and are inclusive of 15% GST.

## Audiovisual Equipment

Equipment	Cost per day	Equipment	Cost Per day
First whiteboard	Complimentary	Lecturn	NZ \$25.00
Flipchart	NZ \$25.00	Projection Screen	Complimentary

All the above pricing is inclusive of 15% GST unless otherwise stated and are subject to change.

We work closely with a local audiovisual supplier and can arrange additional equipment based on your specific requirements.

## Internet

Complimentary wireless internet is available in the conference room.



# Food & Beverage

## Catering

When planning your catering we offer several different solutions and can tailor menus to suit dietary requirements and your budget. Refreshments are served in the conference room, however a breakout area can be arranged if preferred. Dinner themes are a great way to make a statement or create a memorable evening and our conference team can supply detailed menus and theme ideas.

<b>Arrival tea and coffee</b>	NZ \$6.00
<b>Morning or afternoon tea</b>	From NZ \$12.50
<b>Working Lunch</b>	From NZ \$34.00
<b>Buffet Lunch</b>	From NZ \$39.00
<b>Canapés</b>	From NZ \$20.00
<b>Buffet dinners</b>	From NZ \$70.00
<b>Plated dinners</b>	From NZ \$69.00

All prices are per person and include 15% GST.

## One80° Restaurant

Wellington is known as the culinary capital, famous for tucked-away bars, quirky cafes, award-winning restaurants and One80° Restaurant is no exception. With talented, award-winning chefs who fuse together seasonal local ingredients and a touch of city flair, complemented by views over the Wellington Harbour, the culinary experience at One80° is outstanding. From casual dining to an exclusive welcome reception for your conference, One80° is the place to be.

## One80° Cocktail Lounge

Located on level 7, the One80° Cocktail Lounge provides spectacular 180° views of Oriental Bay. Enjoy a relaxed setting while indulging your taste buds with a delectable menu and exquisite wine list. One80° Cocktail Lounge provides an ideal area for conference registration or for informal breakout groups. It's a great place to unwind at the end of the day or to meet prior to starting your evening's fun.

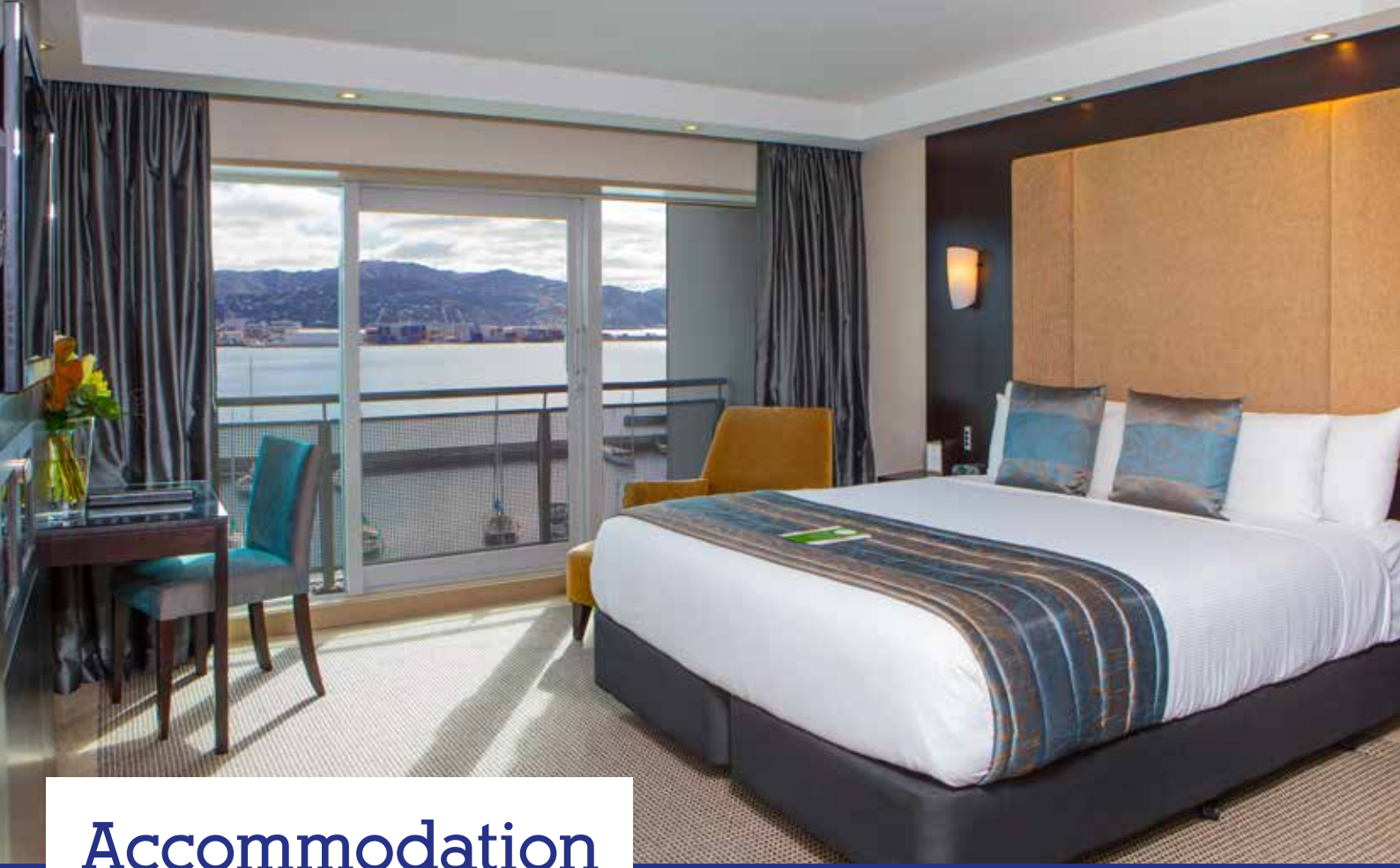

## Accommodation

Copthorne Hotel Wellington Oriental Bay has a total of 118 accommodation rooms consisting of 59 superior rooms, 55 superior plus rooms and 4 suites.

### Superior Room

Simple yet sophisticated, relax in comfort while enjoying stunning city views of Wellington. These beautifully decorated rooms contain one queen and one single bed configuration and an ensuite bathroom with walk in shower.

### Superior Harbour View Room

Outfitted with amenities that any modern traveller requires, this room also provides breathtaking partial views of the harbour from your private balcony. Bed configuration consists of one king or two double beds.

### Deluxe Harbour View Room

Your private balcony frames the beautiful Wellington Harbour - a perfect accompaniment to your New Zealand experience. These spacious rooms are available in a variety of configurations including a family option and the ensuite bathroom has a walk in shower. Triple rooms offer shower over bath.

### Suite

With modern design and décor, each suite has spectacular views of both the harbour and the city from a private balcony. Offering a separate lounge area, the suites have one king bedroom and an ensuite bathroom with walk-in shower and bath.

### All rooms feature

Flat screen televisions with Sky channels, high speed internet access, clock radio, desk, refrigerator, tea and coffee facilities, direct dial telephones with voicemail and message options, ironing facilities and hair dryers.

Check-in: 2.00pm

Check-out: 10.00am



# Event Legacy

Do you like the idea of your event leaving a legacy? Knowing that your event can contribute to meaningful change in both the community and environment? Millennium Hotels and Resorts work with two great organisations; Save the Kiwi to help protect our national icon; the kiwi and Good Bitches Baking who spread kindness for those facing tough times.

## Save the Kiwi

Every little bit counts towards creating a sustainable future and that's why we're offering a unique way for you to contribute towards providing a meal for our national icon; the kiwi.

Choosing not to have your room serviced during an event helps us to conserve water and energy resources that will be redirected towards helping provide kiwi chicks a safe place to sleep and grow until they reach the all-important 'stoat-proof' weight of 1kg.

For every five rooms that are not fully serviced, we will donate one bed for a kiwi at the Save the Kiwi crèche in Napier on behalf of your organisation.



## Business Bitching

Looking for a volunteering and team building event that's not like most others? We've got you!

- Learn from a pastry chef.
- Bake some deliciousness.
- Spread some kindness.
- Have a great time.

Host your meeting in one of Copthorne Hotel Wellington Oriental Bay meeting rooms with a scrumptious morning or afternoon tea, lunch and drinks, with a side of team building to break up the work.

During (or before or after!) your meeting, settle into the beautiful Millennium venue kitchen to bake something delicious with the help of one of their very clever pastry chefs. When the baking is done you'll quality check it and pack it up to be delivered to one of Good Bitches Baking's recipient organisations.





## Activities & Attractions

Your conference or event can be more than just a way to meet - it can also be a reward, a learning experience or a chance to celebrate. From team building and incentive trips to partner and tour programs, our expert conference team are here to make it easy tailoring, the ultimate experience to suit your group and budget.

From culture to coffee, music to moviemaking, Wellington's sights and sounds will leave you wanting more. Arts, culture, fine dining and breathtaking natural scenery - that's what Wellington's all about. Enjoy the panoramic views of the city and harbour from the Mt Victoria Lookout, ride the historic Wellington Cable Car or taste your way around the best city eateries, Wellington is said to have more bars and restaurants per capita than New York City! Come face-to-face with the closest living relative to a dinosaur at Zealandia, get a taste of Wellywood at the Weta Cave movie museum or just watch the world go by at Oriental Bay, the capital's golden sand inner-city beach.

Wellington's waterfront is a beautifully walkable public space, dotted with cafes, parks, sculpture, bars and ice cream vendors. Cruise down the bohemian haven Cuba Street, home to hipsters, artists, lovers of vintage and some of the city's most colourful shops, bars and cafes.



## Contact Us

### **Copthorne Hotel Wellington, Oriental Bay**

100 Oriental Parade  
Oriental Bay, Wellington, New Zealand 6011  
Conference Manager: Lana Allen  
Telephone: +64 4 385 0279  
Email: [lane.allen@millenniumhotels.co.nz](mailto:lane.allen@millenniumhotels.co.nz)

### **Millennium Hotels and Resorts National Conference Office**

Toll Free within New Zealand: 0800 4 MEETINGS (0800 4 633 846)  
Telephone: +64 3 367 3302  
Email: [meetings@millenniumhotels.co.nz](mailto:meetings@millenniumhotels.co.nz)



[www.meetingsnz.co.nz](http://www.meetingsnz.co.nz)

*Our Locations*

PREMIUM



LIFESTYLE



COMFORTABLE

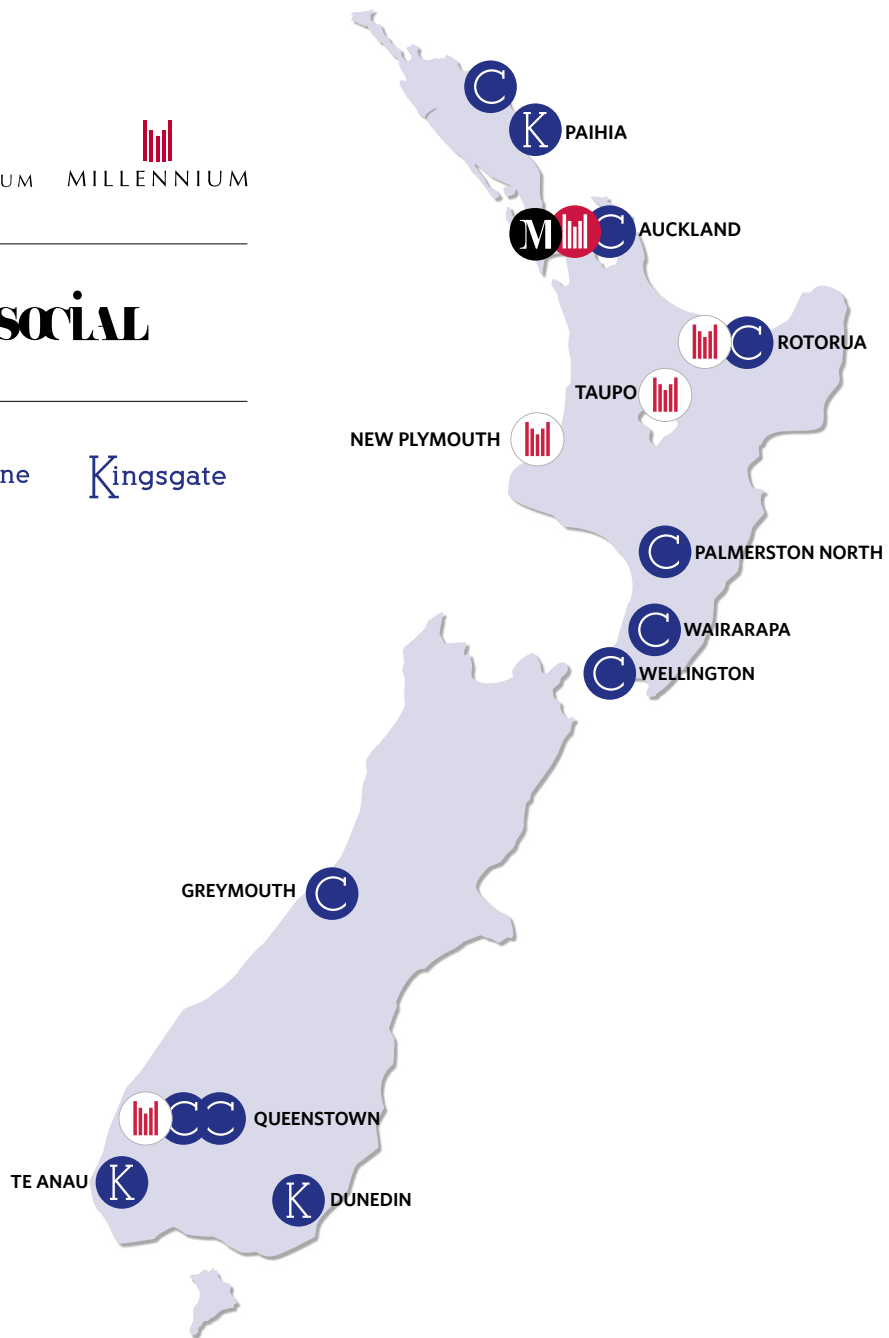

**0800 4 633 846**

W [meetingsnz.co.nz](http://meetingsnz.co.nz) | [millenniumhotels.co.nz](http://millenniumhotels.co.nz)

New Zealand +64 3 367 3302 | E [meetings@millenniumhotels.co.nz](mailto:meetings@millenniumhotels.co.nz)